



EAST WEST

SCHOOL OF  
ARCHITECTURE



# THE FRAME

WOMEN EMPOWERMENT

"You have to really believe not only in yourself; you have to believe that the world is actually worth your sacrific-

-Ar. Zaha Hadid

20  
23



[www.facebook.com/iwssa](http://www.facebook.com/iwssa)



[#iwssa](https://www.instagram.com/iwssa)



[www.iwssa.edu.in](http://www.iwssa.edu.in)

## HIGHLIGHTS:

- Cover Story .....2  
The Exposure.....3  
Abstract & Extract.....4  
Studio 'n' Beyond .....5-6  
Hands on Paper.....7  
Extra Brainsssss.....8



EMPOWERING  
WOMEN

HIGHLIGHTS & COVER STORY...  
Volume III - Jan, Feb, Mar 2023

COVER STORY

HIGHLIGHTS &



### Editor's Vocal:



The empowerment and autonomy of women and the improvement of their political, social, economic and health status is a highly important goal in itself. In addition, it is essential for the achievement of sustainable development. The full participation and partnership of both women and men is required in productive and reproductive life, including shared responsibilities for the care and nurturing of children and maintenance of the household.

Ar. Chandan kumar Rajak (Dean, Academics)

### "Empowering Women"

International Women's Day (IWD) is a global day celebrated annually on March 8 as a focal point in the women's rights movement, bringing attention to issues such as gender equality, reproductive rights, and violence and abuse against women. Marked annually on March 8th, International Women's Day is one of the most important days of the year to the teachers and students of East West School of Architecture. This Women's Day, EWSA embraced women's achievements and gender equality by organizing a celebration at the premises. The women faculties, helping staff and students cut the cake, thus acknowledging the dignity, integrity, efforts and contribution of the women thus marking safe and keen atmosphere with equal opportunities and growth.



## Smt. Rashmi Ravikiran ,Chairman, East West Group of Institutions

ARCHITECTURE IS NOT JUST ABOUT A FEW MANDATORY COURSES AND ELECTIVE PROGRAMS, IT IS A PROCESS INTENDED TO BRING ABOUT TRANSFORMATION IN YOUR PERSPECTIVE AND IS ABOUT GIVING YOU NEW THOUGHTS, NEW VISIONS AND NEW AMBITIONS WITH SCIENTIFIC APPROACH, WITH LIBERALIZATION AND GLOBALIZATION, THE INDIA CORPORATE SECTORS FELT THE NEED TO REPOSITION ITSELF, QUICKLY IN ORDER TO EFFECTIVELY RESPOND TO EMERGING COMPETITION AND ALSO EXPLOIT THE OPPORTUNITIES. THE NEW CHALLENGES WILL NOT BE SURMOUNTED WITH YESTERDAY'S CONCEPTS AND THE DAY BEFORE YESTERDAY'S STRATEGIES AND TECHNOLOGIES BUT RATHER WITH OUR ABILITY AND THINKING FUTURISTIC AND REDEFINING OUR ACTION PLAN FOR TODAY.



SMT. RASHMI RAVIKIRAN

### EXPOSURE

SMT. RASHMI RAVIKIRAN

ZAHA HADID

MAJOR WORK OF ZAHA HAID

TO CATER TO THIS REQUIREMENT, WE AIM TO LIVE UP TO OUR MISSION TO GROOM YOUNG FUTURE ARCHITECTS TO BE COMPLETE, VALUE-DRIVEN HUMAN BEINGS AND COMPETENT PROFESSIONALS WITH GLOBAL OUTLOOK AND CAPABLE OF FUNCTIONING IN CROSS FUNCTIONAL TEAMS.

## The Miraculous Zaha Hadid- The Limitless Imagination

DAME ZAHA MOHAMMAD HADID (31 OCTOBER 1950 – 31 MARCH 2016) WAS BORN IN BAGHDAD, IRAQ. HADID WAS AN IRAQI-BRITISH ARCHITECT, ARTIST AND DESIGNER, RECOGNISED AS A MAJOR FIGURE IN ARCHITECTURE OF THE LATE-20TH AND EARLY-21ST CENTURIES. HADID STUDIED MATHEMATICS AS AN UNDERGRADUATE AND THEN ENROLLED AT THE ARCHITECTURAL ASSOCIATION SCHOOL OF ARCHITECTURE IN 1972. IN SEARCH OF AN ALTERNATIVE SYSTEM TO TRADITIONAL ARCHITECTURAL DRAWING, AND INFLUENCED BY SUPREMATISM AND THE RUSSIAN AVANT-GARDE, HADID ADOPTED PAINTING AS A DESIGN TOOL AND ABSTRACTION AS AN INVESTIGATIVE PRINCIPLE TO "REINVESTIGATE THE ABORTED AND UNTESTED EXPERIMENTS OF MODERNISM TO UNVEIL NEW FIELDS OF BUILDING.



ZAHA HADID  
PRITZKER PRIZE  
WINNER



ROMO'S MANNI MUSEUM

SOME  
WORKS  
OF  
ZAHA  
HADID

HYDER ALIEV MUSEUM



SHE WAS DESCRIBED BY THE GUARDIAN AS THE "QUEEN OF THE CURVE", WHO "LIBERATED ARCHITECTURAL GEOMETRY, GIVING IT A WHOLE NEW EXPRESSIVE IDENTITY".

- Understand- Build –Learn
- Study-Document-Understand

### ➤ Understand- Build –Learn

Understanding the needs to be able to design a kitchen is crucial as understanding the design along with installation is very important. The Kitchen Installation Workshop was conducted for all the students of EWSA scheduled from 20th-24th December, 2022. This workshop helped the students to not only understand the process of designing the kitchen but also gained hands on experience which will be always remembered by them.



### ➤ Study-Document-Understand

Case study and documenting information gives one various ideas and let them peek into the minds of various architects who used their years of experience and dedicated their time to creating such fine structures. As a part of Architectural Design curriculum, the students conducted case studies for their AD Studio with respect to their design topic.

#### CASE STUDY - GOKULAM HOTEL - [ 5 STAR ]



The AD-5 Studio dealt with Transit Hub project and hence conducted case study of Majestic area.

The AD-7 Studio dealt with Meta & Performative Building Design project and hence conducted case studies of Hotel Gokulam.



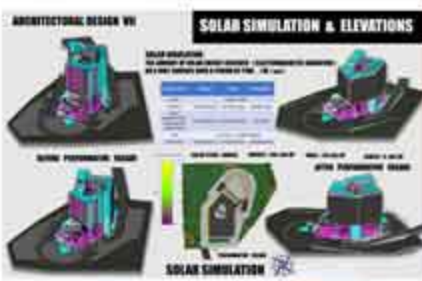

AD \_ VII

MMBC - VII



PERFORMATIVE ARCHITECTURE - 3 STAR HOTEL

STUDIO

Studios enable the students to experience each of these courses and develop affection for them. Great designs could be achieved by keeping the simple principles in mind. An architectural design internship familiarizes you with the a-day-in-the-life of an architectural firm.



ID

INTERNSHIP

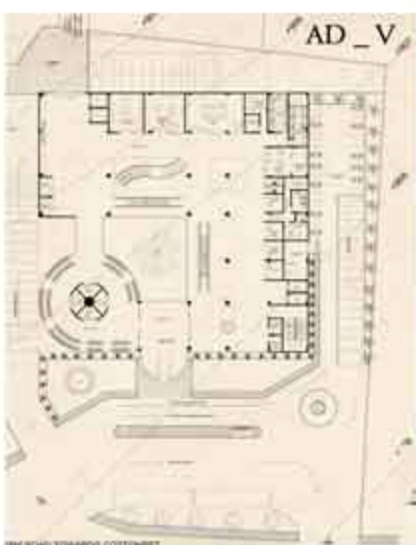

**Welcoming Seniors:** - As Internships and other experiential learning opportunities is the final key to maximizing the value of their college degree, it also helps to fill the gap between the theoretical learning at class room and practical application at work place.



BEYOND

WELCOMING SENIORS

WELCOMING FRESHERS



**Welcoming Freshers:**

Meeting many new people and making new friends. Freshers' party is a way to introduce the new students to their seniors and to the staff. It is a way to welcome them to the college.

Freshers' party is a fun-filled event, which is meant to entertain the new students. It is a way to make them feel comfortable in the new environment. Freshers' party is usually organized on the first day of the new session.





## CONTRIBUTION OF WOMEN ARCHITECTS IN INDIA

The contribution of Women in any field is rarely acknowledged, the Architecture community is no exception to this. Zaha Hadid and Kazuyo Sejima for instance, who have made their own niche in the field and have been worthy of acknowledgement.

**Ar. Urmila Eulie Chowdhury** and **Ar. Sheila Sri Prakash** were the first Indian women Architects also the Asian continent.

**Ar. Chitra Vishwanath** is an architect based in Bengaluru, currently the MD of BIOME Environment Solutions who is expressed concern regarding ecology in architecture. Who started the architectural firm in 1991, and worked on many projects in India and Africa. She has the credit of completing 500 projects with specific relevance to the ecology of the sites context.

**Ar. Brinda Somaya** who is based in Mumbai, began her career in 1978. Brinda spent time in rural India received inspiration from vernacular architecture which are reflected in her buildings in the Indian heritage, architectural styles, they are also traditional and sustainable. she was also the first to woman to win the Wienerberger Golden Architect Award for her lifetimeachievement.

### MENTOR INKS



*This women's day let us throw light on the Indian women architects who have contributed to pronounce Architecture in India and the world over.*



**Conservative Architect Abha Narain Lambah** based in New delhi showed her passion and respect for Indian culture and attention to minute details.

Sanskriti Award, Eisenhower Fellowship, The Attingham Trust and Charles Wallace fellowship are all to her credit

## GUESS THE NAME OF CITY

1



2



3



4



5



6



7



### MATCH THE STYLE

- |  |                   |
|--|-------------------|
| 1 Hoysala Temple                               | a. Nagara         |
| 2 Brihadisvara Temple                          | b. Indo saracenic |
| 3 Ajanta caves                                 | c. Indo Islamic   |
| 4 Khajuraho Temple                             | d. Gothic         |
| 5 Red Fort, Delhi                              | e. Buddhist       |
| 6 Chhatrapati Shivaji Maharaj Terminus, Mumbai | f. Vesara         |
| 7 St. Philomena's Cathedral, Mysuru            | g. Dravidian      |

### REMEMBERING AR. B V DOSHI

1. ZWROK SPACE OF BV DOSHI \_\_\_\_\_
2. CAMPUS BUILDING BASED ON THE DESIGN OF THE TOWN \_\_\_\_\_
3. THE RECIPIENT OF THE PRESTIGIOUS AGA KHAN AWARD FOR ARCHITECTURE IN 1996 \_\_\_\_\_
4. AN UNDERGROUND ART GALLERY IN AHMEDABAD \_\_\_\_\_
5. DOSHI WAS AWARDED THE PRITZKER ARCHITECTURE PRIZE IN \_\_\_\_\_
6. MUSEUM BUILT TO PRESERVE MANUSCRIPT & ARTEFACTS \_\_\_\_\_
7. SHRI B V DOSHI WAS MENTORED UNDER FAMOUS ARCHITECTS LIKE \_\_\_\_\_

Louis Kahn

1. Sangath, 2. IIM, Bengaluru 3. Aranya Low Cost Housing, Indore 4. Amdavad ni Gufa, 5. March 2018, 6. Lalbhai Institute of Indology, 7. Le Corbusier and

Remembering Ar. B V Doshi

1-f, 2-g, 3-c, 4-a, 5-c, 6-b, 7-d

Match the Style

6- Istanbul, 7- Paris

1- Delhi, 2- London, 3- New York, 4- Athens, 5- Rome,

Guess the name of City

Answer:

### What's Next:

- ▶ Annual Exhibition 2023
- ▶ Address by Ar. Pankaj Modi
- ▶ Furniture Design Workshop

<https://www.instagram.com/uvwcm>  
<https://www.youtube.com/channel/UCvWcm>  
[uvwcm@uvwcm.com](mailto:uvwcm@uvwcm.com)  
<https://www.facebook.com/UVWCM>